

Casco Bay

Casco Bay

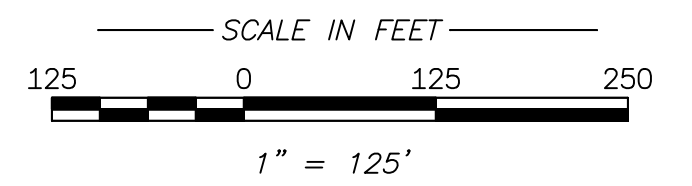
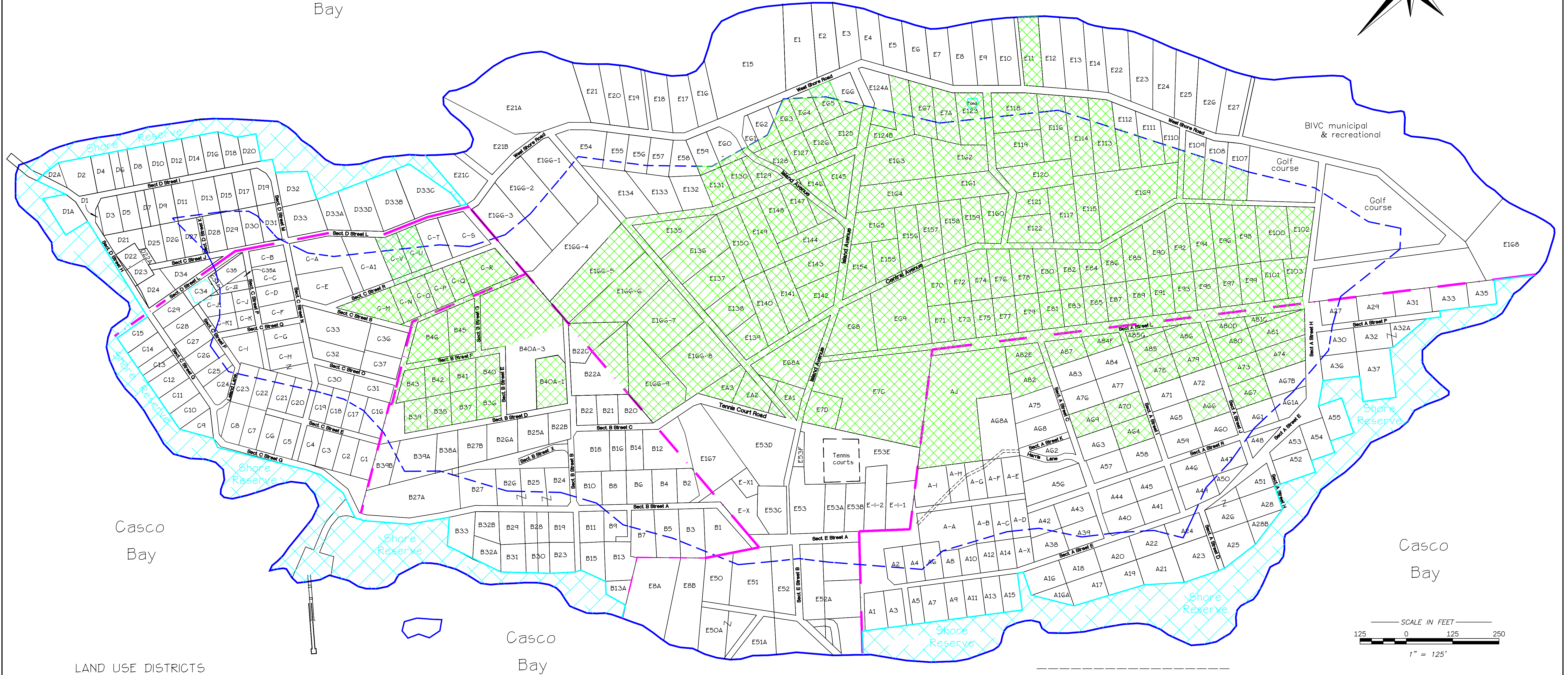
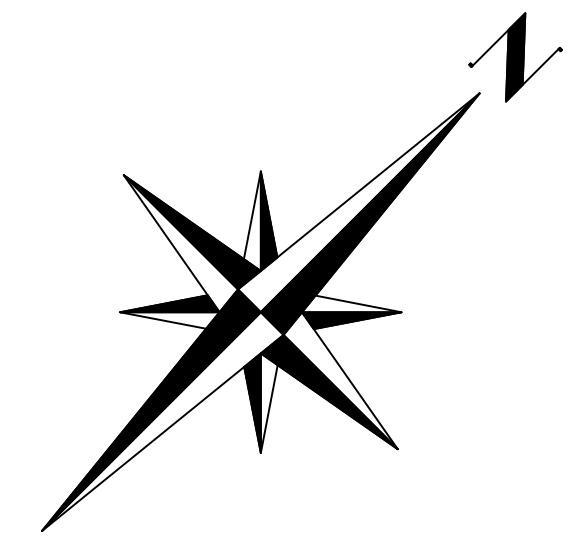

LAND USE DISTRICTS

Shore Reserve

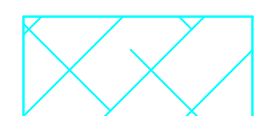

Resource Protection District

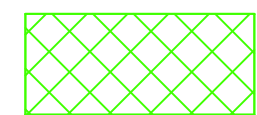

Upland limit of Shoreland district

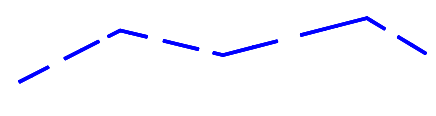

Approximate "normal" high tide line



Section line



NOTES

- 1) The location of "normal" high tide and of the Shoreland Zone shown hereon is approximate, based on 1978 photogrammetry by the James Sewall Co. of Old Town, Maine. "Normal" high tide is assumed to be six feet above mean tide, as shown on the Sewall plan. The current Zoning Ordinance defines a Shoreland District which is to "begin at the normal high water line of the waters surrounding the Island and extend inland on a horizontal line 250 feet."
- 2) Lot lines shown hereon are approximate, and are intended solely for the purpose of parcel identification. For more specific information, refer to boundary surveys recorded at the Cumberland County Registry of Deeds.

Revised to show changes made by the Bustins Island Village Corporation through 2015.

John Bradley Wood
Professional Land Surveyor

Clerk. Bustins Island Village Corporation

Chairman. Planning Board

STATE OF MAINE
 CUMBERLAND, ss. REGISTRY OF DEEDS
 Received
 at _____H. _____M. _____M. and
 recorded in Plan Book _____ Page _____
 ATTEST: _____
 REGISTRAR

Zoning Map
 of
Bustins Island Freeport, Maine
 made for
Bustins Island Village Corporation
 August 1, 2015

Island Surveys 125 Spinney Mill Road
 Arrowsic, Maine 04530